



May 2017 Revision -  
**Quick Coupling Division**  
 8145 Lewis Road  
 Minneapolis, MN 55427  
 phone 763 544 7781  
 fax 763 544 3418

# SUBSEA COUPLING SOLUTIONS

## DSK Series Data Sheet

DSK Series couplings are designed for 20,000psi service in the most demanding applications. Industry leading flow performance, low separation force and metal primary seals provide confidence for connection and disconnection at full pressure and depths to 3000 meters.

### Features:

- Sizes 1/4"
- 20,000 psi (1379 bar) WP
- Design in accordance to API 17TR8
- Poppet valves
- Redundant sealing
- Metal primary seal, PEEK secondary seal
- Parker Nitrile O-rings standard
- Body material: Nitronic® 50HS
- Internal component materials: Nitronic® 50HS and ToughMET® AT110. Springs and lock rings are Inconel® 718 and Elgiloy™.

### Options:

- Various O-ring materials
- Guide sleeve
- Vented valving
- Welded assembly or 2-piece threaded version
- Various end configurations: Autoclave, Weld prep, tube stub (others available upon request)
- Rear plate mounting

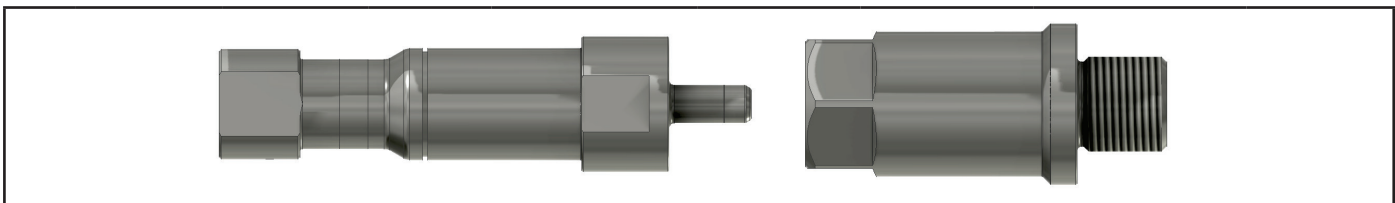

Size	Working Pressure (psi/bar)	Rated Working Depth (ft/m)	Cv per Coupling Half	Separation Force (lb/1000 psi & N/100 bar)	Water Ingress per Connect (ml)	Poppet Crack Pressure (psi/bar)	Length* (in/mm)	Min. Plate Bore Diameter* (in/mm)
1/4"	20,000/1379	10,000/3050	1.4	142/915	2.2	200/13.8	Male: 3.6/91	0.875/22.23
							Female: 3.6/91	

Data given is representative of the coupling series. Individual couplings may vary based on specific configuration of fittings/optional features.  
 \* Minimum bore diameter and length are reference. May change for a specific plate configuration.